



The Regional District of Nanaimo (RDN) is in receipt of an Official Community Plan (OCP) and Zoning Amendment Application for the properties shown in the location map below.

NOTICE OF OCP AND ZONING AMENDMENT APPLICATION

APPLICATION NO. PL2021-048

1800 & 1810 Galvin Place and
PIDs 024 585 912 and 000 441 724

Electoral Area F

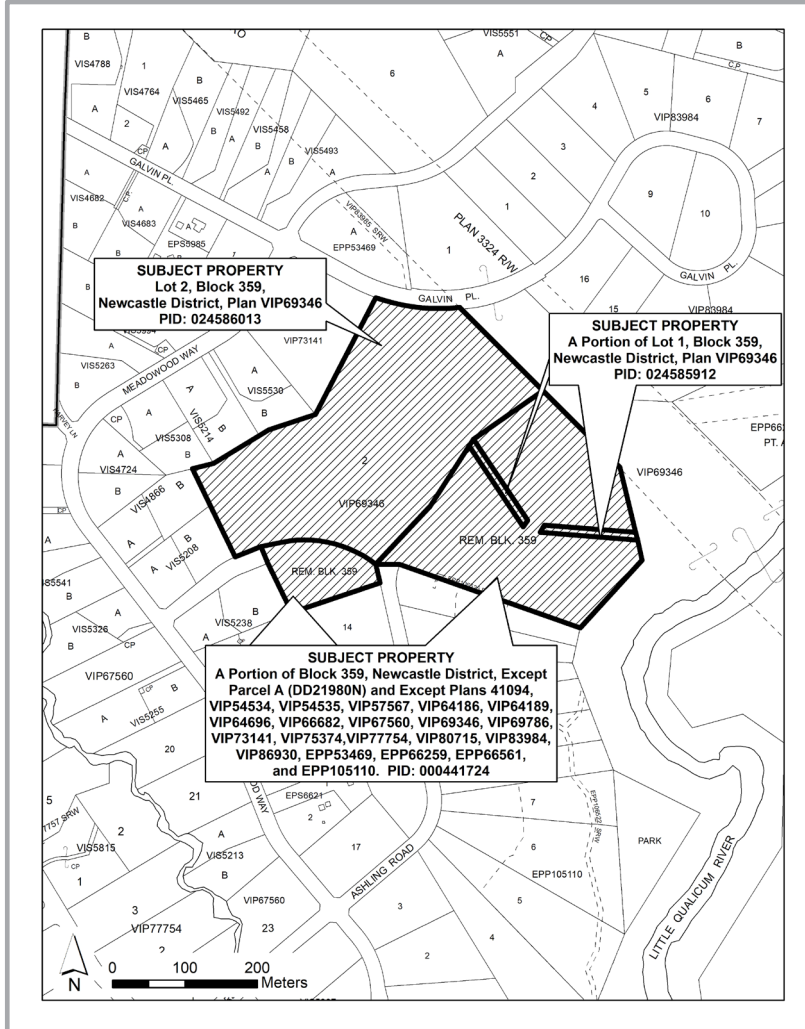

PURPOSE OF PROPOSED BYLAW

The applicant proposes to re-align zoning and OCP land use designation boundaries for the subject properties to facilitate a 9-Lot subdivision and land exchange of private lands and RDN park land. The proposed subdivision will result in six new village residential lots; a separate lot for the existing Meadowood Fire Hall; additional road dedication to connect Ashling Road to Galvin Place, and an exchange of community and regional park land to improve public access to both the Little Qualicum River Regional Park and the Meadowood Community Park. See attached Proposed Plan of Subdivision.

HAVE YOUR SAY AND ASK QUESTIONS

The public is invited to provide feedback and submit questions about the proposed OCP and zoning amendment application online at www.getinvolved.rdn.ca/pl2021-048.

Comments and questions may also be submitted by email to planning@rdn.bc.ca or mail to the RDN Administrative Building at 6300 Hammond Bay Road, Nanaimo, B.C., V9T 6N2. Feedback must be received by August 30, 2022. A summary of the comments received will be provided to the applicant, the Electoral Area Services Committee and RDN Board as part of the application review process.

WHERE CAN I INSPECT THE APPLICATION?

If you are unable to access this application information online, please contact us by email or phone for a staff member to review it with you.

HAVE YOUR SAY

For more information about this application, to provide feedback and submit questions go to:

www.getinvolved.rdn.ca/pl2021-048

For more information, please contact:

☎ 250-390-6510 or 1-877-604-4111

✉ planning@rdn.bc.ca

Get Involved RDN!

www.rdn.bc.ca

Proposed Plan of Subdivision

